

SPRING-LOADED CONNECTORS

SERIES 858 • 4MM GRID RUGGED FLAT FACE TARGET CONNECTOR • SURFACE MOUNT AND THROUGH HOLE MOUNT



- Rugged Target Connectors for use on 4mm grid, supplied in 2 - 6 position connectors
- Target Connectors provide an excellent gold-plated conductive mating surface for spring loaded connectors. These series are offered with a flat face for making contact with our standard .050" dia. spring pin plunger
- Target connectors use MM #1959-0 and #1969-0 pins. See page 223.5 for details
- Mounting tabs provide a means for secure attachment to the PCB and may be specified with or without threaded inserts
- High temperature thermoplastic insulators are suitable for wave and reflow processes
- Series 858-10-00X-10-0X1000 connectors are designed for manual placement into .048±.003" Ø plated through-holes in the circuit board prior to soldering
- Series 858-10-00X-30-0X1000 and 858-10-00X-30-6X1000 connectors are designed for manual placement onto .100" Ø solder pads

Series 858-10-00X-10-0X1000

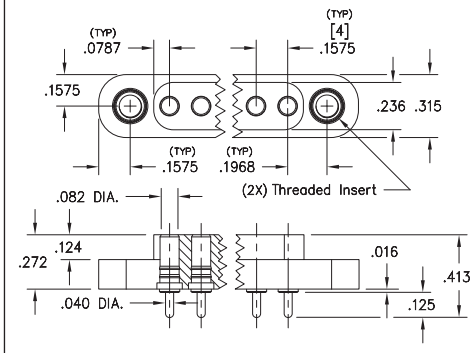

Series 858-10-00X-30-0X1000

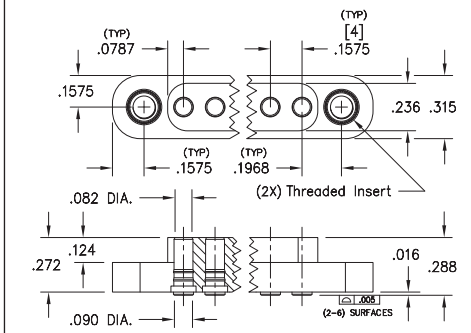

Series 858-10-00X-30-6X1000

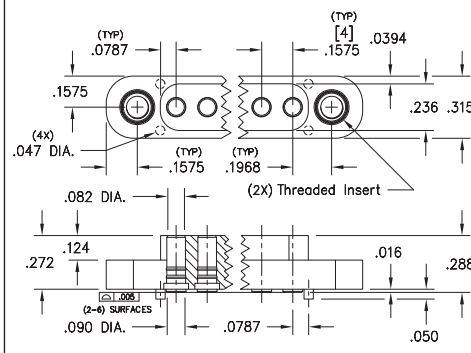

ORDERING INFORMATION

Series 858 (Through-Hole Mount)

858-10-00X-10-0X1000

Specify number of pins 2-6 → ↑ No Threaded inserts = 0
 (#4-40) Threaded inserts = 1

Series 858 (Surface Mount)

858-10-00X-30-0X1000

Specify number of pins 2-6 → ↑ No Threaded inserts = 0
 (#4-40) Threaded inserts = 1

Series 858 (Surface Mount with Alignment Pins)

858-10-00X-30-6X1000

Specify number of pins 2-6 → ↑ No Threaded inserts = 0
 (#4-40) Threaded inserts = 1



XX=Plating Code
See Below

For
Electrical, Mechanical
& Environmental Data,
See page 264

SPECIFY PLATING CODE XX=	10 ◆		
Pin Plating 	10 μ" Au		

