

# INTERCONNECTS

## SERIES 416 • 2,54 GRID ELEVATED • DOUBLE ROW STRIPS

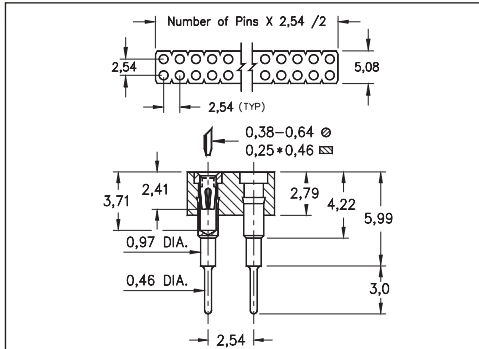

**FIG. 1**

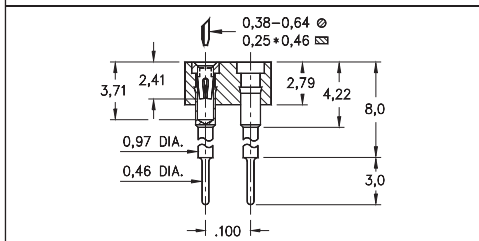

**FIG. 2**

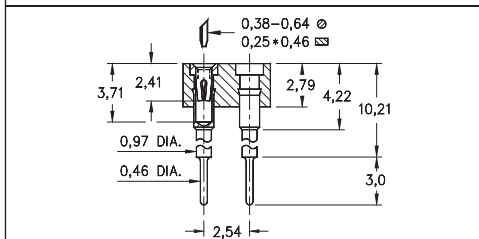

**FIG. 3**

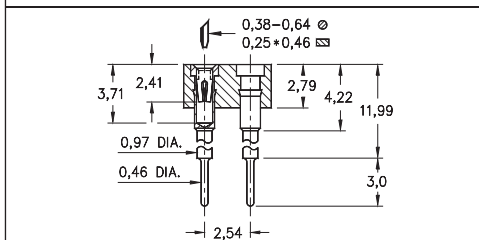

**FIG. 4**

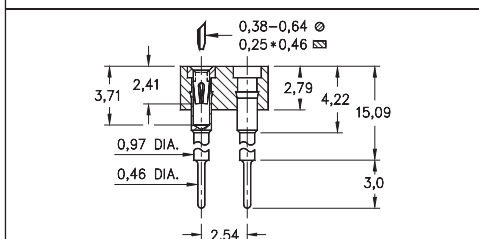

**FIG. 5**

- Elevated socket strips are available in 5 different heights:

416...006 uses pin # 0153-1  
 416...003 uses pin # 0153-2  
 416...007 uses pin # 0153-3  
 416...008 uses pin # 0153-4  
 416...001 uses pin # 0153-5  
 See page 167 for details

- Hi-Rel, 4-finger BeCu #30 contact is rated at 3 amps. See page 253 for details

- Insulators are high temperature thermoplastic, suitable for all soldering operations

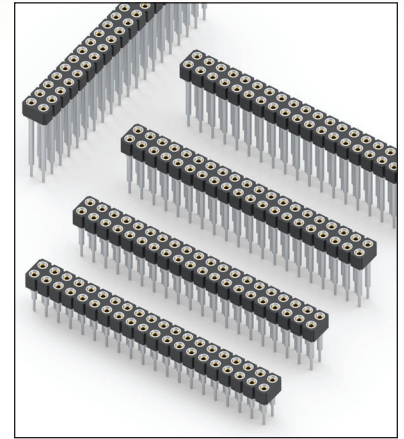

### ORDERING INFORMATION

	Series 416...006	Standoff Height = 5,99
<b>FIG. 1</b>	416-XX-2	-41-006000
	Specify number of pins	04-64
	Series 416...003	Standoff Height = 8,0
<b>FIG. 2</b>	416-XX-2	-41-003000
	Specify number of pins	04-64
	Series 416...007	Standoff Height = 10,21
<b>FIG. 3</b>	416-XX-2	-41-007000
	Specify number of pins	04-64
	Series 416...008	Standoff Height = 11,99
<b>FIG. 4</b>	416-XX-2	-41-008000
	Specify number of pins	04-64
	Series 416...001	Standoff Height = 15,09
<b>FIG. 5</b>	416-XX-2	-41-001000
	Specify number of pins	04-64



XX=Plating Code  
See Below

For  
Electrical, Mechanical  
& Environmental Data,  
See page 264

SPECIFY PLATING CODE XX=	91	93	41	43
Sleeve (Pin)	5,08µm Sn/Pb	5,08µm Sn/Pb	5,08µm Sn	5,08µm Sn
Contact (Clip)	0,25µm Au	0,76µm Au	0,25µm Au	0,76µm Au

