

SPRING-LOADED PINS

DISCRETE SPRING-LOADED CONTACTS • THROUGH-HOLE MOUNT

0906-0

0906-0-15-20-76-14-11-0

Short stroke, Solder mount in 0,51 min. mounting hole. Also available with insulated sleeve, see page 19.5

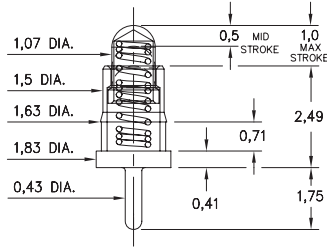

0906-1 ⇨ 4,8

0906-X-15-20-7X-14-11-0

Standard stroke, Solder mount in 0,51 min. mounting hole. Also available with insulated sleeve, see page 19.5

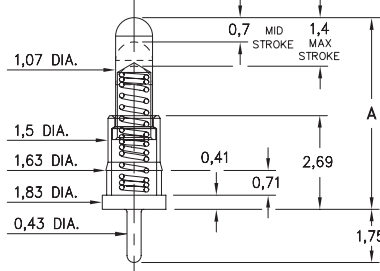

| Basic Part Number | Length A |
|-------------------|----------|
| 0906-1 | 4,5 |
| 0906-2 | 5,0 |
| 0906-3 | 5,51 |
| 0906-4 | 5,99 |
| *0906-8 | 3,94 |

*0906-8 has a 0,5 Mid. Stroke & 1,0 Max. Stroke

0930

0930-0-15-20-7X-14-11-0

Solder mount in 0,51 min. mounting hole. Also available on carrier tape: 1,500 parts per 13" reel. Order as: 0930-0-57-20-7X-14-11-0

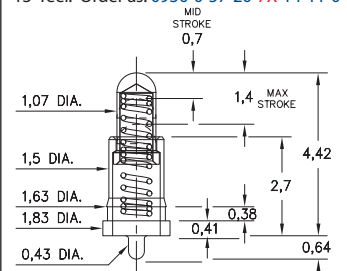

0914

0914-0-15-20-77-14-11-0

Long stroke Solder mount in 0,74 min. mounting hole

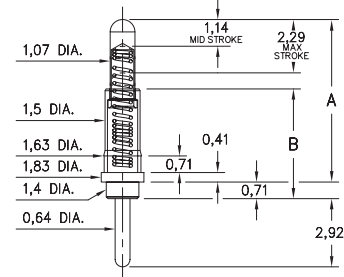

| Basic Part Number | Length A | Length B |
|-------------------|----------|----------|
| 0914-0 | 6,96 | 4,7 |
| 0914-1 | 7,72 | 6,15 |
| 0914-2 | 8,48 | 6,91 |
| 0914-3 | 9,25 | 7,67 |

0908-0 ⇨ 9

0908-X-15-20-7X-14-11-0

Standard stroke Solder mount in 0,51 min. mounting hole

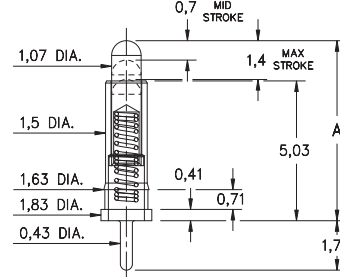

| Basic Part Number | Length A |
|-------------------|----------|
| 0908-0 | 6,48 |
| 0908-1 | 6,99 |
| 0908-2 | 7,49 |
| 0908-3 | 8,0 |
| 0908-4 | 8,51 |
| 0908-5 | 8,89 |
| 0908-6 | 9,4 |
| 0908-7 | 9,91 |
| 0908-8 | 10,41 |
| 0908-9 | 10,92 |

0932

0932-0-15-20-77-14-11-0

Long stroke Solder mount in 0,74 min. mounting hole

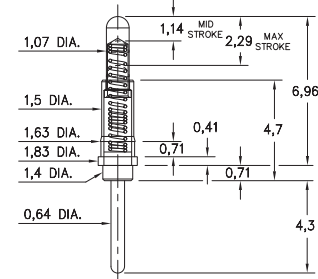

0901

0901-0-15-20-7X-14-11-0

"Legacy P/N 0901-0-00-00-00-00-11-0" Solder mount in 0,74 min. mounting hole

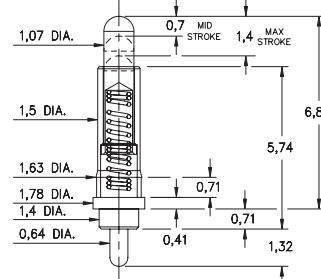

0929

0929-X-15-20-7X-14-11-0

Standard stroke Solder mount in 0,74 min. mounting hole

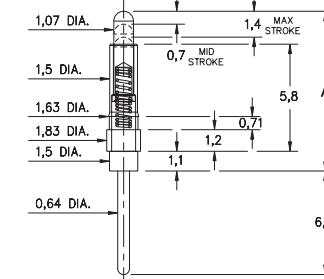

| Basic Part Number | Length A |
|-------------------|----------|
| 0929-0 | 8,64 |
| 0929-7 | 12,2 |

Material Specifications:

Sleeve & Plunger Material: Copper Alloy
Spring Material: Beryllium Copper
Sleeve & Plunger Finish: 0,5µm Gold over Nickel
Spring Finish: 0,25µm Gold over Nickel
Dimensions: Millimeters
Tolerances On: Lengths: ± 0,15
 Diameters: ± 0,051
 Angles: ± 2°



Mechanical & Electrical Specifications:

Durability: Up to 1,000,000 cycles
Current Rating: 2A continuous, 3A peak
Contact Resistance: 20 mΩ max.
Environmental Specifications:
Operating temperature range: -55/+125° C (discontinuous)

75, 76, 77 Springs are not interchangeable

Order Code: 09XX - X - 15 - 20 - 7X - 14 - 11 - 0

Spring Number

| Spring Number | Mid. Stroke | Max. Stroke | Force @ Mid. Stroke | Initial Force (Pre-Load) |
|---------------|-------------|-------------|---------------------|--------------------------|
| 75 | 0,7 | 1,4 | 60 g | 25 g |
| 76 | 0,5 | 0,99 | 60 g | 25 g |
| 77 | 1,14 | 2,29 | 60 g | 25 g |

