

SPRING-LOADED CONNECTORS

SERIES 858 • 4MM GRID RUGGED CONCAVE FACE TARGET CONNECTOR • SURFACE MOUNT AND THROUGH HOLE MOUNT

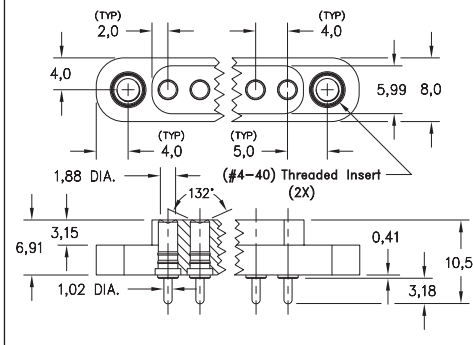

Series 858-10-00X-10-0X2000



Series 858-10-00X-30-0X2000

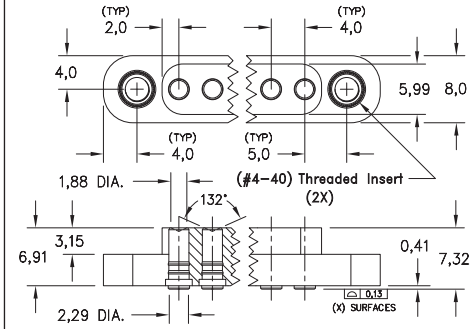

Series 858-10-00X-30-6X2000

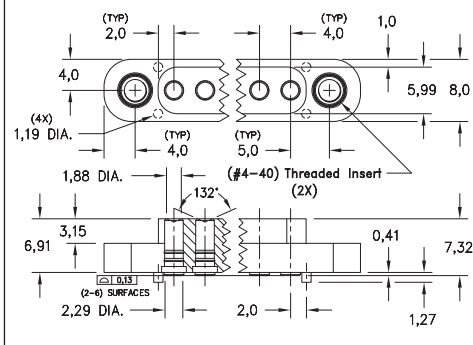

- Rugged Target Connectors for use on 4mm grid, supplied in 2 - 6 position connectors
- Target Connectors provide an excellent gold-plated conductive mating surface for spring-loaded connectors. These series are offered with a concave face providing additional surface area for mating with our 858-22-00X-X0-XX1101 series spring-loaded connectors
- Target connectors use MM #1959-1 and #1969-1 pins. See page 223.5 for details
- Mounting tabs provide a means for secure attachment to the PCB and may be specified with or without threaded inserts
- High temp. thermoplastic insulators are suitable for wave and reflow soldering processes
- Series 858-10-00X-10-0X2000 connectors are designed for manual placement into 1,22±0,76 Ø plated through-holes in the circuit board prior to soldering
- Series 858-10-00X-30-0X2000 and 858-10-00X-30-6X2000 connectors are designed for manual placement onto 2,54 Ø minimum solder pads

ORDERING INFORMATION

Series 858 (Through-Hole Mount)

858-10-00X-10-0X2000

Specify number of pins 2-6

No Threaded inserts = 0
(#4-40) Threaded inserts = 1

Series 858 (Surface Mount)

858-10-00X-30-0X2000

Specify number of pins 2-6

No Threaded inserts = 0
(#4-40) Threaded inserts = 1

Series 858 (Surface Mount with Alignment Pins)

858-10-00X-30-6X2000

Specify number of pins 2-6

No Threaded inserts = 0
(#4-40) Threaded inserts = 1



XX=Plating Code
See Below

For
Electrical, Mechanical
& Environmental Data,
See page 264

SPECIFY PLATING CODE XX=	10		
Pin Plating 	0,25 µm Au		

