

# SPRING-LOADED PINS

## DISCRETE SPRING-LOADED CONTACTS • SURFACE MOUNT

### 0910-0

0910-0-57-20-76-14-11-0

Short stroke, Surface mount  
Packaged on 16mm wide carrier tape: 2,000 parts per 13" reel  
See page 28.4 for Tape & Reel details

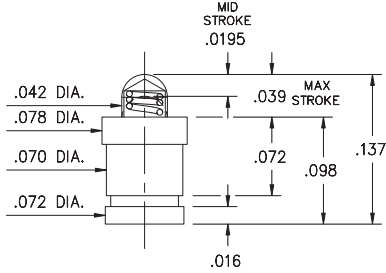

### 0910-1⇔4

0910-X-57-20-7X-14-11-0

Standard stroke, Surface mount  
Packaged on carrier tape. See chart for tape width & qty. per reel  
See page 28.4 for Tape & Reel details

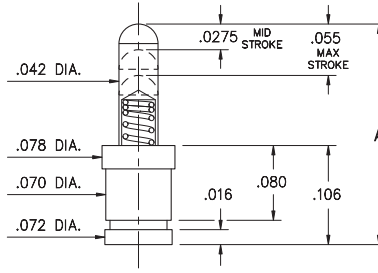

Basic Part Number	Length A
0910-1	.177
0910-2	.197
0910-3	.217
0910-4	.236

Basic Part Number	Tape Width	Quantity per Reel
0910-1	16mm	1,500
0910-2	24mm	1,100
0910-3	24mm	1,100
0910-4	24mm	1,100

### 0910-8

0910-8-57-20-76-14-11-0

Short stroke, Surface mount  
Packaged on 16mm wide carrier tape: 1,800 parts per 13" reel  
See page 28.4 for Tape & Reel details

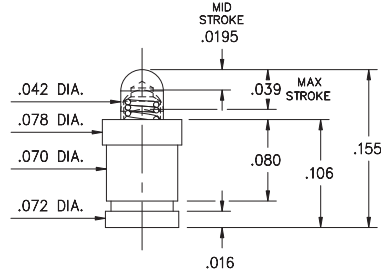

### 0990-0

0990-0-50-20-76-14-11-0

Short stroke, Surface mount, Large base  
Also available on 16mm wide carrier tape: 2,150 parts per 13" reel  
See page 28.3 for Tape & Reel details

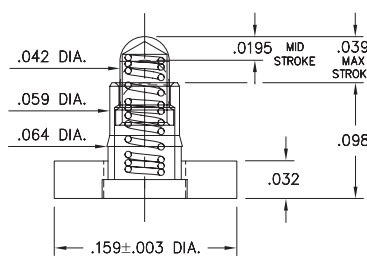

### 0990-1⇔4

0990-X-50-20-7X-14-11-0

Standard stroke, Surface mount, Large base  
Also available on 16mm wide carrier tape: 850 parts per 13" reel  
ONLY 0990-4 currently available. See page 28.3 for Tape & Reel details

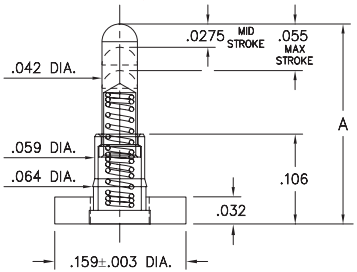

Basic Part Number	Length A
0990-1	.177
0990-2	.197
0990-3	.217
0990-4	.236

### 0997-0⇔9

0997-X-50-20-7X-14-11-0

Standard stroke, Surface mount, Large base, Mid profile

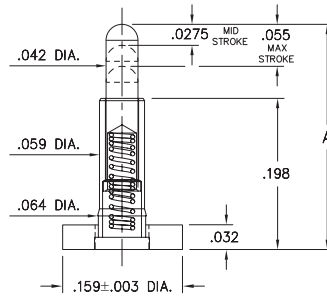

Basic Part Number	Length A
0997-0	.255
0997-1	.275
0997-2	.295
0997-3	.315
0997-4	.335
0997-5	.350
0997-6	.370
0997-7	.390
0997-8	.410
0997-9	.430

#### Material Specifications:

**Sleeve & Plunger Material:** Copper Alloy  
**Spring Material:** BeCu or Stainless Steel 302 \*  
**Sleeve & Plunger Finish:** 20 μ" Gold over Nickel  
**Spring Finish:** 10 μ" Gold over Nickel  
**Dimensions: Inches**  
**Tolerances On:** Lengths: ± .006  
Diameters: ± .002  
Angles: ± 2°



#### Mechanical & Electrical Specifications:

**Durability:** Up to 1,000,000 cycles  
**Current Rating:** 2A continuous, 3A peak  
**Contact Resistance:** 20 mΩ max.

#### Environmental Specifications:

**Operating temperature range:**  
-55/+125° C (discontinuous)

**09, 75, 76 Springs are not interchangeable**

Order Code: 09XX - X - XX - 20 - XX - 14 - 11 - 0

Spring Number

Spring Number	Mid. Stroke	Max. Stroke	Force @ Mid. Stroke	Initial Force (Pre-Load)
09	.015	.030	65 g	XX g
75	.0275	.055	60 g	25 g
76	.0195	.039	60 g	25 g

