

PIN RECEPTACLES

FOR .015" - .025" DIAMETER PINS

3530

3530-0-15-XX-30-XX-10-0

Also available in HSMT connector series:

835-XX-0XX-40-030001

1,450 parts per 13" reel

See page 87.3 for Tape & Reel details

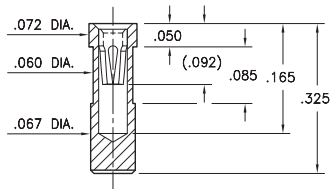

<p>3530 3530-0-15-XX-30-XX-10-0 Also available in HSMT connector series: 835-XX-0XX-40-030001 1,450 parts per 13" reel See page 87.3 for Tape & Reel details</p>			

SPECIFICATIONS:

Shell Material: Brass Alloy 360, 1/2 Hard

Contact Material: Beryllium Copper Alloy 172, HT

Dimensions: Inches

Tolerances On: Lengths: ±.005

Diameters: ±.002

Angles: ± 2°



ORDER CODE: XXXX - 0 - 15 - XX - 30 - XX - 10 - 0

BASIC PART #

SPECIFY SHELL FINISH:

- 01 200 μ" TIN/LEAD OVER NICKEL
- ◆ 80 200 μ" TIN OVER NICKEL (RoHS)
- ◆ 15 10 μ" GOLD OVER NICKEL (RoHS)

SPECIFY CONTACT FINISH:

- 02 100 μ" TIN/LEAD OVER NICKEL
- ◆ 80 200 μ" TIN OVER NICKEL (RoHS)
- ◆ 27 30 μ" GOLD OVER NICKEL (RoHS)

SELECT CONTACT:

#30 CONTACT

(For alternate contact choices, see group A on page 248)

