

# MALE PCB PINS

## SOLDER TERMINALS PIN TYPE

### 2318

2318-X-00-XX-00-00-07-0

Swage mount in .062 hole

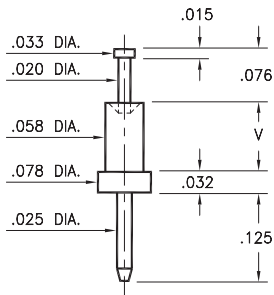

Basic Part Number	Board Thickness	Length V
2318-1	.031	.051
2318-2	.062	.082
2318-3	.094	.113

### 2309

2309-X-00-XX-00-00-07-0

Swage mount in .064 hole

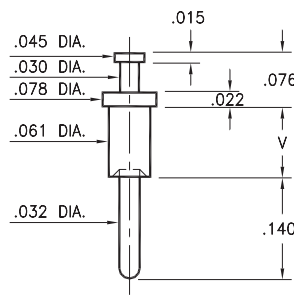

Basic Part Number	Board Thickness	Length V
2309-1	.031	.054
2309-2	.062	.084
2309-3	.094	.115
2309-4	.125	.147

### 2514

2514-2-00-XX-00-00-07-0

Press-fit in .070 mounting hole

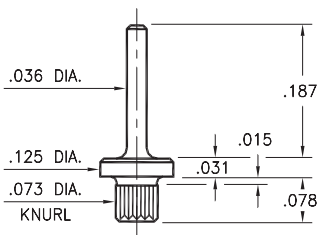

### 8602

8602-1-00-XX-00-00-07-0

Square press-fit in .032 plated through-hole

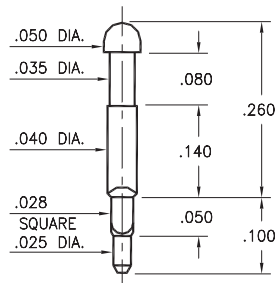

### 3050

3050-X-01-XX-00-00-03-0

Press-fit in .032 mounting hole  
For wire sizes up to 26 AWG

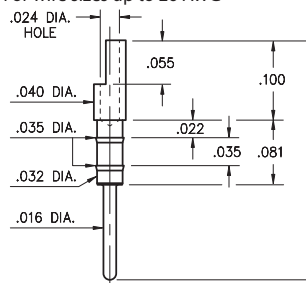

Basic Part Number	Pin Length A
3050-0	.303
3050-3	.376

### 8250

8250-0-00-XX-00-00-03-0

Press-fit in .034 mounting hole

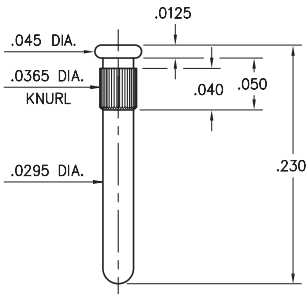

### 9994

9994-0-00-XX-00-00-03-0

Press-fit in .033 mounting hole

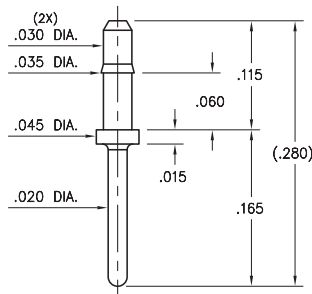

### 9067

9067-0-00-XX-00-00-03-0

Press-fit in .055 mounting hole

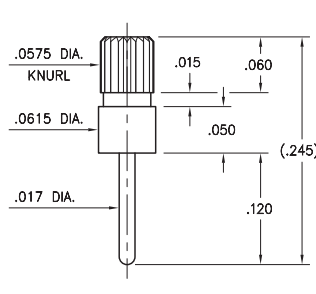

#### SPECIFICATIONS:

**Pin Material:** Brass Alloy 360, 1/2 Hard  
(Swage pins are annealed)

**Dimensions:** Inches

**Tolerances On:** Lengths:  $\pm .005$   
Diameters:  $\pm .002$   
Angles:  $\pm 2^\circ$



ORDER CODE: XXXX - X - 00 - XX - 00 - 00 - 07 - 0

BASIC PART #

SPECIFY PIN FINISH:

- 01 200  $\mu$ " TIN/LEAD OVER NICKEL
- ◆ 80 200  $\mu$ " TIN OVER NICKEL (RoHS)
- ◆ 44 300  $\mu$ " SILVER OVER COPPER (RoHS)
- 50 300  $\mu$ " ELECTRO-SOLDER (60/40 SnPb)

